

Please read and save these instructions. Read carefully before attempting to assemble, install, operate or maintain the product described. Protect yourself and others by observing all safety information. Failure to comply with instructions could result in personal injury and/or property damage! Retain instructions for future reference.

Action Pump Co

Multi Task Pumps

Description

Model 7005 & 7010 fit 5, 6 & 7 gallon containers with a 70mm opening.

Model 7006 is the same as 7005 & 7010, but also fits 15,30 & 55 gallon drums with a 2" FNPT opening.

Model 7008 fits 5, 6 & 7 gallon containers with a 70mm opening and also 15, 30 & 55 gallon drums with a 2" FNPT opening.

Model 7009 is for use in tight places. Comes with a 1/4" O.D. intake tube.

Model 7028 large flow pvc pump fits 15, 30 & 55 gallon drums with a 2" FNPT opening.

Model 7036 extreme flow pump dispenses 1 gallon with only 4 strokes. Fits 15, 30 & 55 gallon drums with a 2" FNPT opening.

Specifications

General Safety Information

1. Always carefully read, thoroughly understand and follow the pump operating instructions. Use this pump correctly and with care for the purpose for which it is intended. Failure to do so may cause damage or personal injury, and will void the warranty. Please retain instructions for future reference.
2. Contact your chemical or fluid supplier to check for compatibility with pump prior to installation and operation.
3. Prior to use, always carefully and thoroughly read and understand the OSHA information contained in the MSDS sheet supplied for the chemical which is to be pumped.
4. Wear protective clothing (goggles, face mask, long sleeves, long pants, gloves, aprons, etc) as set forth in the OSHA Safety Data Sheet when pumping any hazardous chemicals.
7. Pump should be washed out before it is used since processing lubricants may contaminate the fluids.
8. Prior to use, inspect your pump thoroughly verifying its proper assembly.
9. If pump is removed from drum, it should be thoroughly rinsed in a liquid that is compatible with the pump.

Action Heavy Duty Siphon Pump

General Safety Information (Continued)

(*) Any of the NFPA Codes can be obtained from : National Fire Protection Association, Inc., Batterymarch Park, Quincy, MA 0269, telephone 1-800-344-3555. Write or call for listing and prices.

▲ WARNING *Removal of outer garments in work areas where there may be flammable or explosive liquids, which are ignitable with low electrical energy, can be fatal and/or cause property damage (Refer to NFPA 56A, and NFPA 77, for further details).*

4. The "WARNING" and instructions for gasoline below pertain not only to gasoline, but to any flammable, combustible or hazardous fluid.

▲ WARNING *Gasoline is a highly flammable fuel. The improper use, handling or storage of gasoline can be dangerous. Prevent accidents by following these safety rules:*

- a. Use gasoline only as a fuel, never as a cleaning fluid.
- b. Use only an approved container to hold or store gasoline. Never store gasoline in familiar containers such as milk containers or soda pop bottles.
- c. Store gasoline in a cool location, out of the reach of children. Never store gasoline near heat or an open flame.
- d. Provide a fire extinguisher nearby when working with gasoline. Be sure extinguisher is in operating condition — check the pressure gauge or indicator. Be familiar with its proper use. Consult local fire department for the correct type of extinguisher for your application. Extinguishers rated ABC by the National Fire

Protection Association are appropriate for most applications.

- e. Provide positive shut-off valves on all permanent fuel supplies. Fuel lines must be of steel piping, adequately secured, and free from leaks.
 - f. Provide adequate ventilation, and clean up any spills when handling or pumping flammable liquids.
 - g. POSITIVELY NO SMOKING!
5. Do not use torches or apply fire or flame to this pump for any reason.
 6. Secure the discharge line before starting the pump. An unsecured discharge line will slip, possibly causing personal injury and/or property damage.
 7. Do not over tighten nonmetallic threaded fittings. One full turn past hand tight is usually enough to prevent leakage. Teflon sealant tape should be used on all threaded joints, including the spout.
 8. Check hoses for weak or worn condition before each use, making certain that all connections are secure.
 9. Periodically inspect pump and system components. Perform routine maintenance as required.
 10. Drain all liquids from the system before servicing.

▲ WARNING *Any pump used to transfer flammable liquids must be stored in a well ventilated area after use.*

11. Personal Safety

- a. Wear safety glasses at all times when working with pump.
- b. Wear a face shield, proper apparel and suitable respiratory equipment, when pumping

hazardous chemicals.

- c. Keep work area clean, uncluttered, and properly lighted, replace all unused tools and equipment.
- d. Keep visitors at a safe distance from the work area.
- e. Make workshop childproof, with padlocks, master switches, and by removing starter keys.

▲ WARNING *Failure to follow all general safety information can result in a fatality, personal injury and/or property damage!*

Installation

1. Always carefully read, and follow the pump operating instructions.
2. Attach hose (Ref. No. 2) and hose clamp (Ref. No. 1) firmly to discharge spout.

▲ CAUTION *Make sure the clamp is securely tightened.*

3. Attach thumb screw (Ref. No. 4) through bung hole (Ref. No. 3), tighten wing nut (Ref. No. 5).
4. Prior to use, inspect your pump to make sure all fittings are tight and consult your operating manual for safety instructions.
5. Adjust pump to desired height and tighten thumb screw in adapter by hand. **DO NOT USE A WRENCH OR TOOL TO TIGHTEN THUMB SCREW.**

Operation

1. Place pump into drum and take bung adapter (Ref. No. 3) and screw clockwise into container, making sure adapter is securely tightened to container.
2. Place pump discharge tube (Ref. No. 2) into container receiving fluid.
3. Tighten thumb screw on bung adapter to hold pump in place.

Model 5000

General Safety Information (Continued)

4. Grip handle (Ref. A) and pull upward several times with half strokes until all air leaves discharge hose and liquid flows continuously through the discharge hose (Ref. No. 2). At that point pull handle completely upward past the discharge port.
5. To stop liquid flow, push handle down below the discharge port.

⚠ CAUTION *Liquid flow will not stop if discharge hose is submerged in liquid.*

6. If siphon action stops or slows due to low liquid level in drum, either elevate the drum or operate manually to maintain flow. When discharging thick liquids, you may need to operate manually to discharge liquid.
7. To restart liquid flow, repeat Step 4.

8. If pump is removed from drum, rinse thoroughly in liquid that is compatible with both the pump and fluid. For any questions about chemical compatibility, contact your chemical supplier.
9. Normal moisture buildup will occur on handle shaft but will flow back into container.

Maintenance

Normal maintenance is not required.

90-Day Limited Warranty

Action Heavy Duty Siphon Pump

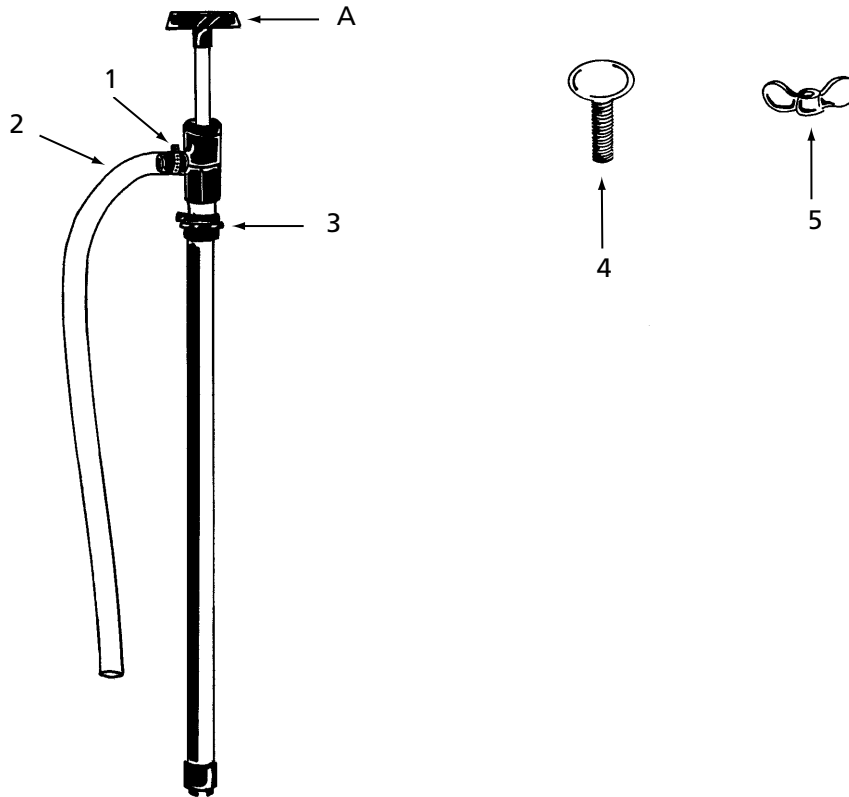

Figure 1 — Replacement Parts Illustration

Replacement Parts List

Reference Number	Description	Material	Part Number	Quantity
1	Hose Clamp	S.S.	1P416	1
2	Discharge Tube	PVC	423-H	1
3	Bung Adapter	PVC	65001	1
4	Thumb Screw	Steel	1650-19	1
5	Wing Nut	Steel	500-W	1

NOTE: For handle (Ref. A) replacement, contact manufacturer.